

MCCONNELSVILLE VILLAGE

SECOND ADDITION -26

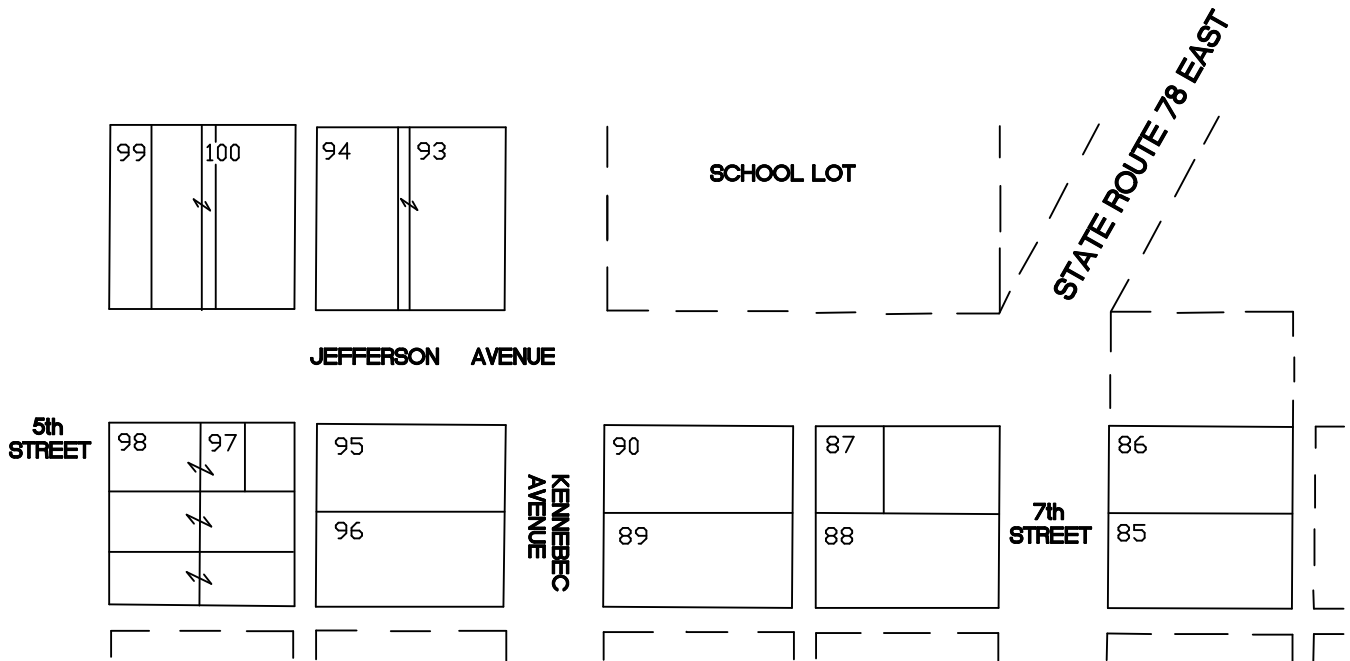

- | | | |
|-----|-------------------------------|-------------|
| 85 | Bonnie Ford | OR 40-703 |
| 86 | Phillip & Rita Lawrence | OR 39-270 |
| 87 | Rusty S Ray | OR 212-292 |
| | John & Deborah Finley | 188-54 |
| 88 | Mark Howdyshell | OR 193-475 |
| 89 | Timothy & Susan Matheney | OR 9-398 |
| 90 | Rhetts Morgan Rentals | OR 121-459 |
| 93 | Heritage Investment Trust | OR 40-524 |
| | Church of the Gospel Ministry | OR 66-256 |
| 94 | Donald Hemry Jr. & Helen | 182-180 |
| | Church of the Gospel Ministry | OR 66-256 |
| 95 | Albert Jackson Hoch | OR 24-694 |
| 96 | Timothy Hopkins | OR 184-281 |
| 97 | N.Eighth LLC | OR 120-351 |
| | Thomas Charles | OR 221-2288 |
| | Julie Ann Lucas | OR 211-1443 |
| | Theodore Scott | OR 222-2567 |
| 98 | Theodore Scott | OR 222-2567 |
| | Julie Ann Lucas | OR 211-1443 |
| | Thomas Charles | OR 221-2288 |
| 99 | Francis Moulton east part 37' | OR 82-613 |
| | Chasey Realty LLC West part | OR 221-1750 |
| 100 | Francis Moulton | 82 -613 |
| | North Eighth Rentals | OR 202-791 |